

# Mini Red Diode Laser PE.SLR.S.650/660.05



## Red Diode Mini Lasers

- \* wide wavelength 650~660 nm
- \* constant output power
- \* external trigger modulation
- \* Mini size dimension 11x28 mm

## Applications

- Machine vision
- Image process, robotics
- 3D contour mapping
- Laser alignment
- Remote sensing



## Specifications

Model	PE.SLR.S.***.05
Wavelength (nm)	635nm, 650nm, 660 nm
Power (mW)	~ 5 mW
Operating voltage (v):	+2.7 VDC ~ +5 VDC
Beam diameter (mm):	3~5 mm
Beam divergence (mrad):	0.5~1.0 mrad
Operating temp:	-10°C ~ +40 °C
Store temp:	-20°C ~ +75 °C
Dimensions (mm):	φ 11x 28 mm
Driver:	+3 ~ +5 VDC PCB Driver

**Option: Red Diode Line Laser is available with the Mini Size Red Diode Laser**

## Dimension Outline:

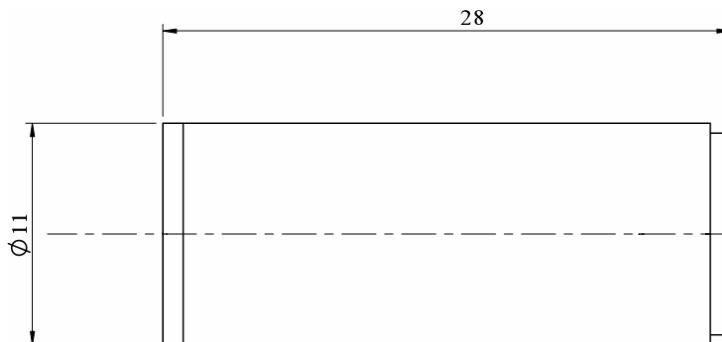

PEGASUS Shanghai Optical Systems CO. LTD.

Tel: 86-21-6762-7294 Fax: 86-21-6762-7244

Email: [sales@pegasus-optik-china.com](mailto:sales@pegasus-optik-china.com) <http://www.pegasus-optik-china.com>